

HARMONIC FOCUS[®]+ Shears

Assembly Guide



Assembly



Using aseptic technique, remove the instrument from the packaging



While holding the Hand Piece, attach the instrument by rotating it onto the Hand Piece in a clockwise rotation

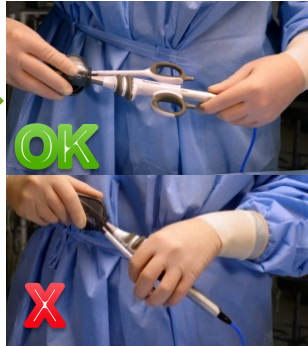

Use the Gray Torque Wrench to tighten the instrument onto the Hand Piece. Turn the wrench clockwise while holding the Hand Piece until it clicks twice.*



Remove the Torque Wrench from the instrument. Do not discard the disposable Torque Wrench until the completion of the surgical case.

***Failure to follow these assembly steps may cause inadvertent damage to the HARMONIC[®] Shears or reusable Hand Piece.**

Pre-Run Testing

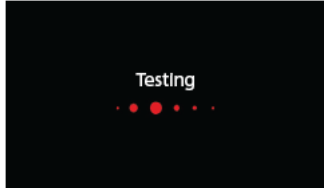

Connect the assembled Hand Piece and instrument to the generator and turn the generator power on. Follow On-Screen Instructions to complete initiation. The test prompt screen appears when the initiation sequence is complete. Activate the instrument (by depressing either one of the triggers) with the **jaws open** for 2 seconds to run test until the HARMONIC[®] ready screen is displayed.

Re-Attaching the Torque Wrench

Close the clamp arm and place the Gray Torque Wrench over the distal end of the instrument.

